



CamContain BTFB Dampers

Bubble-Tight Flat Blade Isolation Dampers



Isolation dampers are designed to isolate the filter housing during the filter service. Isolating the housing protects service personnel during filter changing.

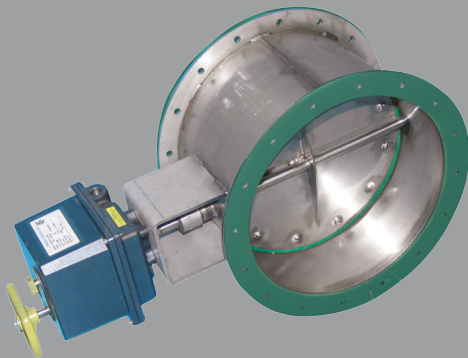

Optional electric actuator with manual hand wheel override. Manual actuators are standard. A wide variety of electric or pneumatic actuators are available.

Camfil CamContain BTFB Round Isolation Dampers¹ create a barrier between hazardous contaminants and the filter change out components typical to a containment system.

Every CamContain Isolation Damper:

- Is functionally an ISOLATION damper as defined by ASME AG-1 Section DA-1320.
- Is manufactured in 7-gauge and 11-gauge 304L stainless steel materials. 316L stainless steel construction is a standard option.
- Is continuously welded at the pressure boundary.
- Is available in a wide variety of sizes, from 6" to 48" in 2" increments.
- Manual actuators are standard and factory installed. Optional pneumatic or electric actuators are available. Contact factory for assistance.
- Includes pre-drilled bolt holes in out-turned flanges for connection to matching housing or duct work.
- May be mounted in parallel.

Typical applications include hospital infectious isolation suites, pharmaceutical facilities, research and biotechnology laboratories, nuclear processing facilities, and various manufacturing operations.

All CamContain Isolation Dampers are manufactured to industry standards and leak tested to bubble-tight integrity.

Custom designs are available to meet any individual containment requirement.

¹ Bubble-tight dampers are qualified to Frame Leakage Class A and Seal Leakage Class 0 per Section DA, Article 5000 of ASME AG-1.

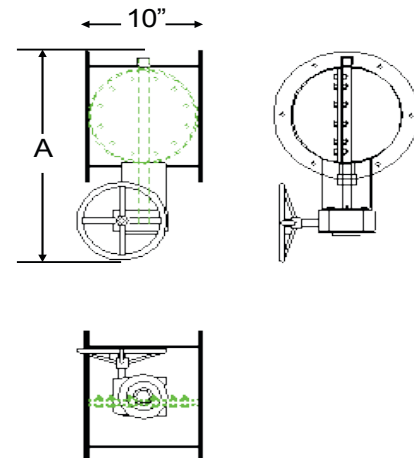



CamContain BTFB Dampers

Bubble-Tight Flat Blade Isolation Dampers

Isolation dampers create a positive shut-off and isolate hazardous contaminants when incorporated in a CamContain filtration system. During filter change, dampers are closed to ensure the safety of filter service personnel.

Isolation dampers are also used where system decontamination is part of the filter change procedure.

Typically, the dampers are closed, after which a decontamination agent is introduced to the internal components of the isolated housing, killing biohazard components.

Injection ports are required on the containment housing for this process.

The BTFB isolation damper is bubble tight at 10" w.g. (Frame Leakage Class A and Seat Leakage Class O per Section DA, Article 5000 of ASME AG-1). Every damper is factory tested per this Code.

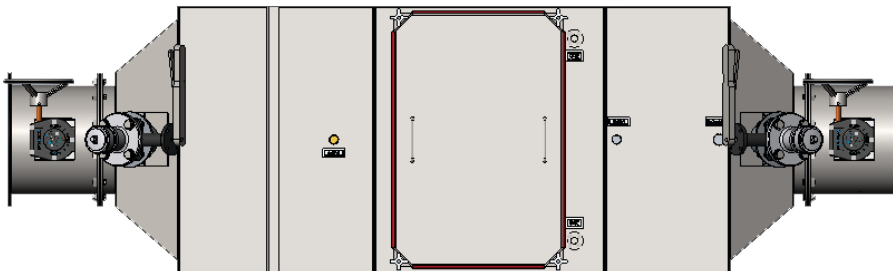

Typically dampers are installed upstream and downstream of the air filters that need to be serviced.

MODEL NUMBER DECODER

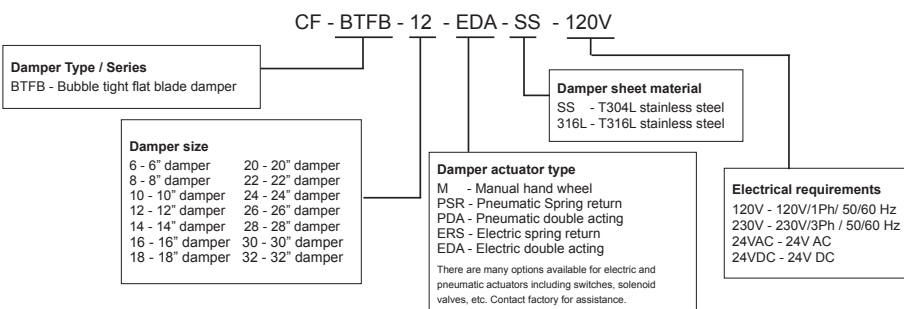

Model Number	Flange Inside Diameter (inches)	Flange Outside Diameter (inches)	Bolt Circle	# of Bolt Holes	Bolt Hole Diameter (inches)	Dimension A	Weight (lbs)
CF - BTFB - 6 - M - SS	6	9	7 ½	8	7/16	17	35
CF - BTFB - 8 - M - SS	8	11	9 ½	8		19	45
CF - BTFB - 10 - M - SS	10	13	11 ½	12		21	50
CF - BTFB - 12 - M - SS	12	15	13 ½	12		23	60
CF - BTFB - 14 - M - SS	14	17	15 ½	16		25	70
CF - BTFB - 16 - M - SS	16	19	17 ½	16		27	80
CF - BTFB - 18 - M - SS	18	21	19 ½	16		29	90
CF - BTFB - 20 - M - SS	20	23	21 ½	20		31	100
CF - BTFB - 22 - M - SS	22	25	23 ½	20		32	115
CF - BTFB - 24 - M - SS	24	27	25 ½	24		34	130
CF - BTFB - 26 - M - SS	26	29	27 ½	24		36	140
CF - BTFB - 28 - M - SS	28	31	29 ½	28		39	155
CF - BTFB - 30 - M - SS	30	33	31 ½	28		41	170
CF - BTFB - 32 - M - SS	32	35	33 ½	28		43	190

Data Notes:

Unit is completely factory assembled. Standard damper includes a manual hand wheel actuator. There are many options when considering electric or pneumatic actuators.

For assistance specific to this product, please contact Camfil's Washington, NC facility at Sales-WA@camfil.com or telephone at (877) 658-6588.



For detailed specifications or drawing, please consult your local Camfil Distributor or Representative or download from the Containment Toolbox located in the **Segments Tab** of **CamTab File Archive** at www.camfil.us.

Camfil has a policy of uninterrupted research, development and product improvement. We reserve the right to change designs and specifications without notice.

Camfil USA | 1 North Corporate Drive, Riverdale, NJ 07457 | Tel: (973) 616-7300

www.camfil.com

